



BEAVER ELECTRICAL MACHINERY
 7440 LOWLAND DRIVE, BURNABY, BC, CANADA
 TEL: (604) 431-5000 FAX: (604) 431-5066
 www.beaverelectrical.com

**AVR SERIES
 SPECIFICATION SHEET**

**3 PHASE TRANSFORMER
 TYPE: DRY TYPE
 FLOOR OR WALL MOUNT**

CAT. NO.: AVR75TT24C
 KVA: 75
 PRIMARY VOLT: 625Y/600
 SECONDARY VOLT: 575Y/550
 PHASE: 3
 FREQ: 60 HZ
 WINDING MATL: Copper
 WEIGHT: 120 LBS
 INSUL. CLASS: 220°C
 TEMP. RISE: 150°C
 TAPS: SEE BELOW
 BIL: 10 kV
 ENCLOSURE: TYPE 2
 TYPE 3R with optional kit
 APPROVALS: UL, CSA

OUTLINE DRAWING

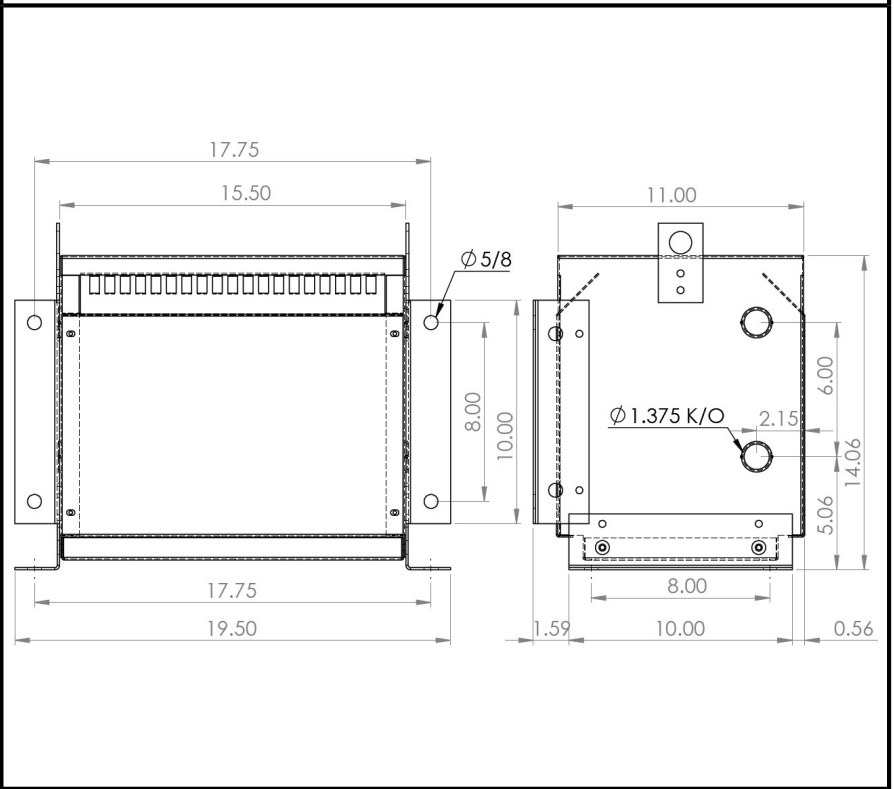

WIRING AND CONNECTION DIAGRAM

VOLT	LINE CONN
625	H1-H2-H3
600	H4-H5-H6
575	X1-X2-X3
550	X4-X5-X6

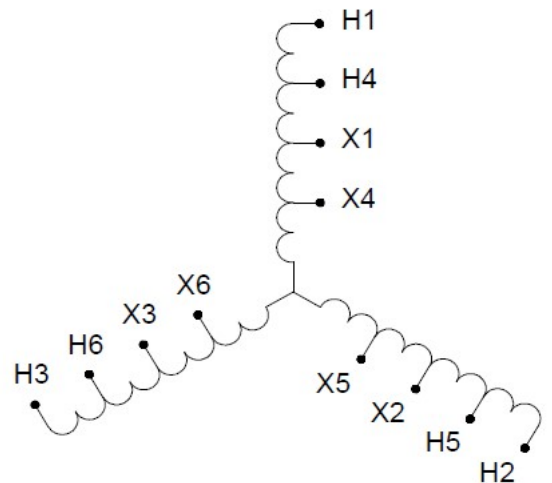

NOTE: Specifications and dimensions subject to change without notice