



BEAVER ELECTRICAL MACHINERY
 7440 LOWLAND DRIVE, BURNABY, BC, CANADA
 TEL: (604) 431-5000 FAX: (604) 431-5066
 www.beavelectrical.com

**AVR SERIES
 SPECIFICATION SHEET**

**3 PHASE AUTO TRANSFORMER
 TYPE: VENTILATED
 WALL OR FLOOR MOUNT**

CAT. NO.: AVR225TT24C
 KVA: 225
 PRIMARY VOLT: 625
 SECONDARY VOLT: 600/575/550
 PHASE: 3
 FREQ: 60 HZ
 WEIGHT: 300 LBS
 INSUL. CLASS: 220°C
 TEMP. RISE: 150°C
 TERMINATIONS: Lug 600MCM - 2 AWG
 WDG. MAT'L: Copper
 BIL: 10 KV
 ENCLOSURE: NEMA Type 1
 Type 3R with optional kit
 APPROVALS: CSA, UL

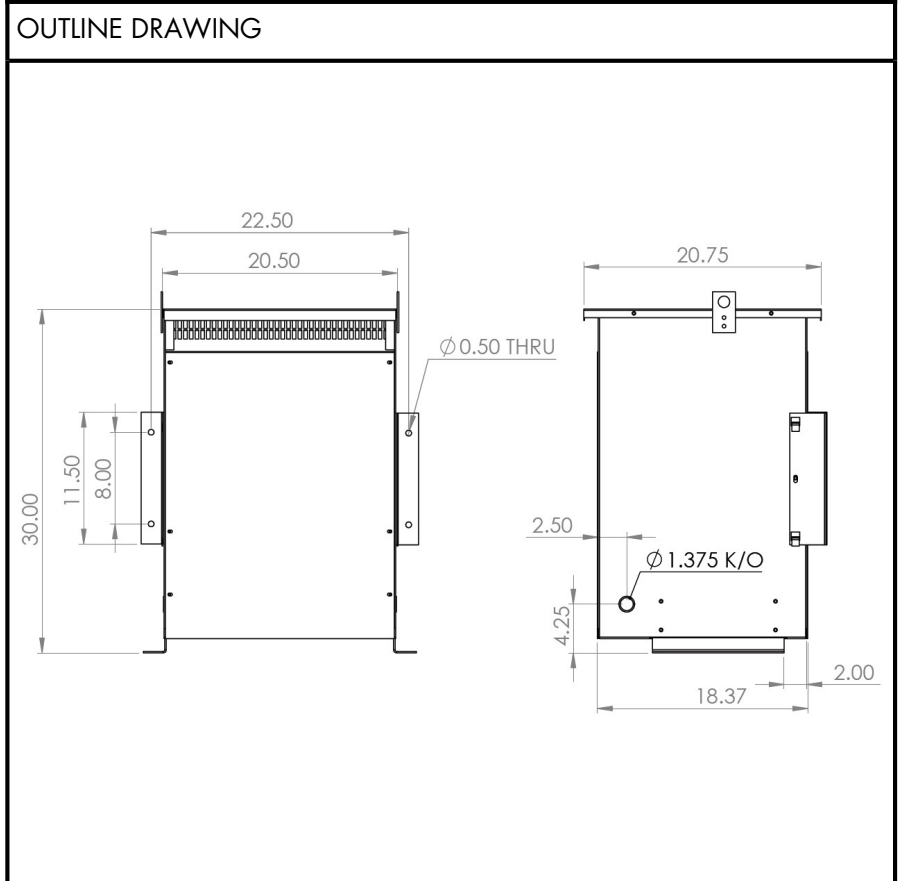

WIRING AND CONNECTION DIAGRAM

Typical rating of 600/625 at 225 kVA, 60 Hz			
High Volt	Connect	Low Volt	Connect
625	H1-H2-H3	600	X7-X8-X9
		575	X4-X5-X6
		550	X1-X2-X3

Alternate rating of 500/480 at 180 kVA, 50/60 Hz			
High Volt	Connect	Low Volt	Connect
500	H1-H2-H3	480	X7-X8-X9
		460	X4-X5-X6
		440	X1-X2-X3

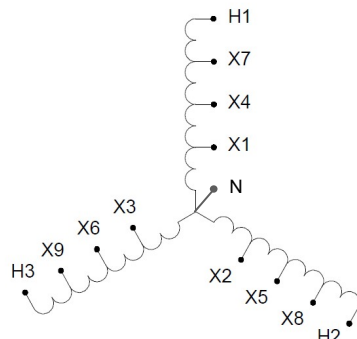

NOTE: Specifications and dimensions subject to change without notice