



BEAVER ELECTRICAL MACHINERY
 7440 LOWLAND DRIVE, BURNABY, BC, CANADA
 TEL: (604) 431-5000 FAX: (604) 431-5066
 www.beaverelectrical.com

**AVR SERIES
 SPECIFICATION SHEET**

**3 PHASE TRANSFORMER
 TYPE: DRY TYPE
 FLOOR OR WALL MOUNT**

CAT. NO.: AVR150SH4A
 KVA: 150
 VOLT: 480Y/208Y
 PHASE: 3
 FREQ: 60 HZ
 WINDING MATL: Aluminum
 WEIGHT: 555 LBS
 INSUL. CLASS: 220°C
 TEMP. RISE: 150°C
 TAPS: SEE BELOW
 BIL: 10 kV
 ENCLOSURE: Type 2
 Type 3R with optional kit
 APPROVALS: UL, CSA

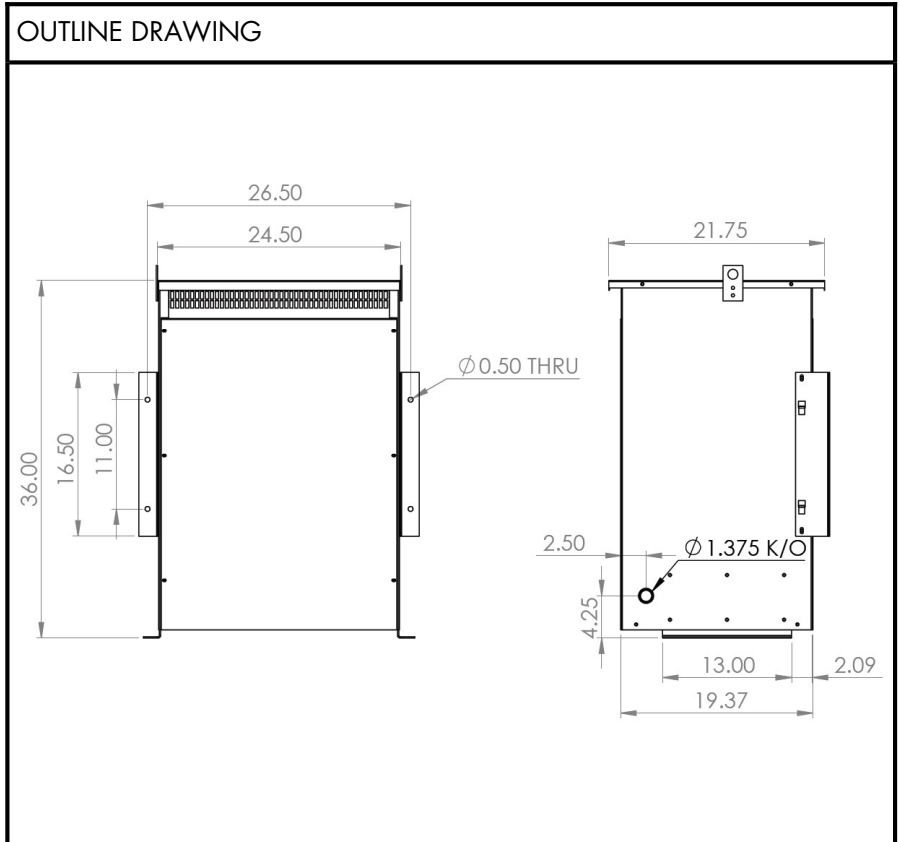

WIRING AND CONNECTION DIAGRAM

VOLT	LINE CONN
504	1-1-1
480	2-2-2
456	3-3-3
208	X1, X2, X3

Supply voltage may be connected to primary terminal marked "H"
 or
 secondary terminal marked "X"
 Review CEC rule 26-266 or CEC handbook figure 26-12 for info

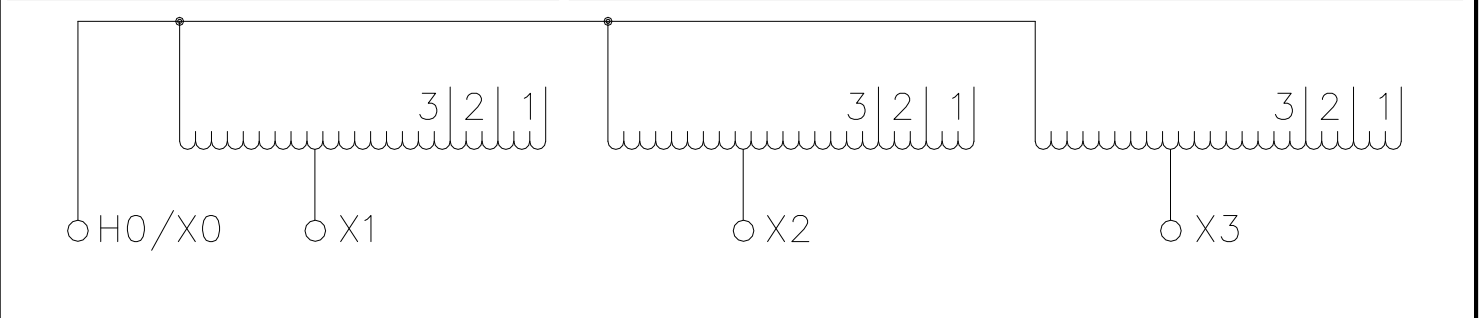

NOTE: Preliminary drawing only.
 Specifications, configuration, and dimensions subject to change by Beaver's Engineering Dept.